

**Rohrzirkulation**  
*tube circulation*

**Merkmale**

Kann entsprechend dem Wellendurchmesser, der Steigung und der Anzahl der Lagerreihen kombiniert werden. Der Anwendungsbereich ist groß, und beide Enden der Gewindelaufbahn der Kugelumlaufspindel können als unvollständige Zähne ausgeführt werden. Der DN-Grenzwert beträgt 100.000.

**Characteristics**

*It can be combined according to the shaft diameter, lead, and the number of bearing rows, and the application range is wide, and both ends of the ball screw threaded raceway can be designed as incomplete teeth. The limit DN value is 100,000.*

**Genauigkeitsklasse und Axialspiel**

**Accuracy class and axial clearance**

Index	Genauigkeitsklasse Accuracy class	Axial Spiel Axial clearance
Positionierung <i>Positioning</i>	C1, C2, C3, C4, C5	0mm(preload) / Vorspannung
Transport <i>Transmission</i>	T1, T2, T3, T4, T5, T7, T10	S:0~0.005mm, M:0~0.02mm, L:0~0.05mm

Bei der Wahl der Genauigkeitsklasse ist auch die „maximale Fertigungslänge der Spindel“ zu berücksichtigen. Für Kugelgewindetriebe zur Positionierung werden in der Regel vorgespannte Produkte verwendet. Für Kugelgewindetriebe zum Transport werden in der Regel Produkte mit Spiel verwendet.

*When selecting an accuracy class, it is also necessary to refer to the „maximum manufacturing length of the lead screw“. The positioning type ball screw pair generally uses preloaded products, and the transmission type ball screw pair generally uses products with play.*

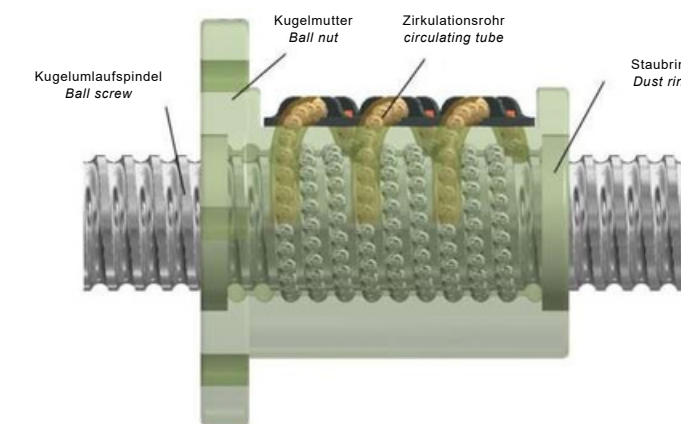

Darstellung der Rohrzirkulation des Rohrlaufs  
*Sketch drawing of tube circulation*

# Einzelflanschmutter

## Single flange nut

FEZG

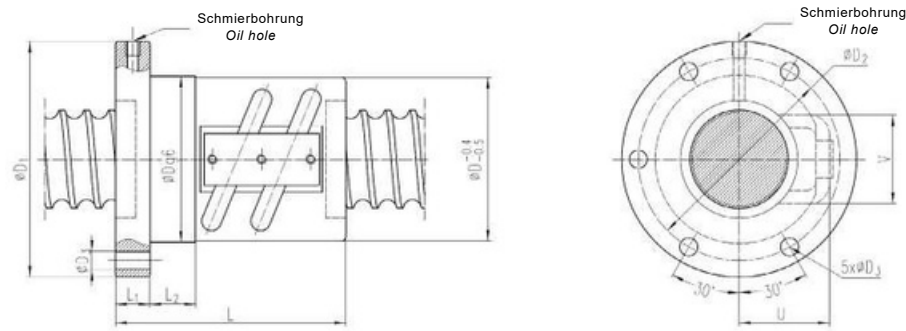

Index	Spindel Ball screw		Kugel- Ø Ball- e	Kugelumlauf- Cycle number x column	D	Flansch Flange			L2	L	D3	hervorstehender Teil der Zirkulationsleitung Prominent part of circulating pipe		Øbohrung Oil hole	Nennlast rated load (N)		Stiffigkeit Rigidity K N/um
	Nenn- Nominal- e	Steigung Lead				D1	D2	L1				U	V		C <sub>dyn</sub>	C <sub>stat</sub>	
FEZG16-5	16	5	3.175	1.5x2	31	54	41	12	15	50	5.5	20	23	M6x1	11650	16150	209
FEZG16-5				45						9962					13460	176	
FEZG16-5				60						18080					26930	341	
FEZG16-5				50						13300					18850	243	
FEZG20-5	20	5	3.175	1.5x2	35	58	46	12	15	50	5.5	22	27	M6x1	13100	20520	248
FEZG20-5				45						11190					17100	208	
FEZG20-5				60						20320					34210	404	
FEZG20-5				50						14950					23940	287	
FEZG20-6	20	6	3.969	1.5x2	36	60	47	12	15	66	5.5	23	28	M6x1	17420	25260	256
FEZG20-6				48						14890					21050	215	
FEZG20-6				66						19890					29470	296	
FEZG20-6				66						19890					29470	296	
FEZG25-6	25	6	3.969	1.5x2	42	68	55	12	15	65	5.5	28	33	M6x1	19580	32080	303
FEZG25-6				50						16740					26730	254	
FEZG25-6				68						30380					53470	494	
FEZG25-6				65						22360					37430	351	
FEZG25-10	25	10	4.762	1.5x2	45	72	58	16	15	75	6.6	29	35	M6x1	24940	38620	324
FEZG25-10				65						21320					32180	272	
FEZG25-10				75						28480					45060	375	
FEZG25-10				75						28480					45060	375	
FEZG32-5	32	5	3.175	1.5x2	50	76	63	12	15	50	6.6	30	39	M6x1	16230	33610	346
FEZG32-5				45						13880					28010	290	
FEZG32-5				60						25190					56030	565	
FEZG32-5				75						35700					84040	834	
FEZG32-5	32	6	3.969	1.5x2	57	78	65	12	15	50	6.6	32	40	M6x1	18540	39220	401
FEZG32-6				55						22240					42280	374	
FEZG32-6				50						19010					35230	314	
FEZG32-6				68						34500					70470	610	
FEZG32-6	32	8	4.762	1.5x2	54	88	70	16	15	55	9	33	42	M6x1	25390	49330	433
FEZG32-8				70						27740					48660	377	
FEZG32-8				62						23710					40550	316	
FEZG32-8				86						43040					81100	615	
FEZG32-8	32	8	4.762	1.5x2	54	88	70	16	15	70	9	33	42	M6x1	31670	56770	473
FEZG32-8				62						23710					40550	316	
FEZG32-8				86						43040					81100	615	
FEZG32-8				70						27740					48660	377	

# Einzelflanschmutter

## Single flange nut

FEZG

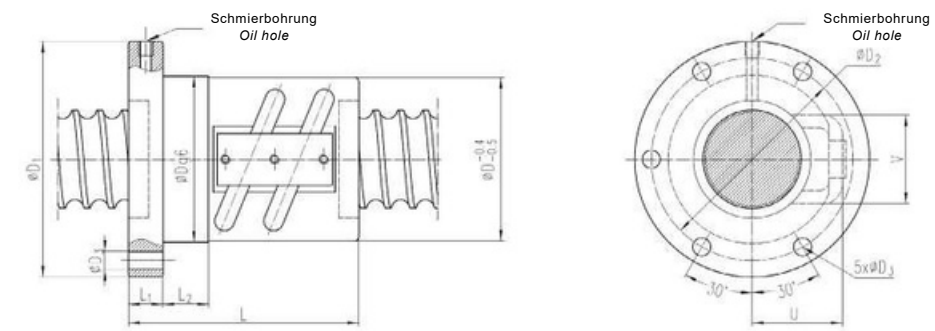

Index	Spindel Ball screw		Kugel- Ø Ball- e	Kugelumlauf- Cycle number x column	D	Flansch Flange			L2	L	D3	hervorstehender Teil der Zirkulationsleitung Prominent part of circulating pipe		Øbohrung Oil hole	Nennlast rated load (N)		Stiffigkeit Rigidity K N/um
	Nenn- Nominal- e	Steigung Lead				D1	D2	L1				U	V		C <sub>dyn</sub>	C <sub>stat</sub>	
FEZG32-10	32	10	6.35	1.5x2	57	91	73	16	15	78	9	37	45	M8x1	40580	64630	398
FEZG32-10				68						34690					53860	334	
FEZG32-10				98						62960					107720	649	
FEZG32-10				78						46330					75410	461	
FEZG40-5	40	5	3.175	1.5x2	58	92	72	16	15	55	9	34	47	M8x1	17810	42340	395
FEZG40-5				50						15220					35280	331	
FEZG40-5				65						27640					70570	645	
FEZG40-5				80						39170					105850	953	
FEZG40-5	40	6	3.969	1.5x2	60	94	76	16	15	55	9	36	48	M8x1	20340	49400	458
FEZG40-6				60						24270					52540	419	
FEZG40-6				54						20748					43780	352	
FEZG40-6				72						37660					87570	685	
FEZG40-6	40	8	4.762	1.5x2	62	96	78	16	15	90	9	38	50	M8x1	53370	131350	1011
FEZG40-6				60						27710					61290	486	
FEZG40-8				70						31360					63300	450	
FEZG40-8				62						26810					52750	378	
FEZG40-8	40	10	6.35	1.5x2	65	106	85	18	20	86	11	42	52	M8x1	48660	105510	734
FEZG40-8				70						35800					73860	521	
FEZG40-10				82						45610					82100	470	
FEZG40-10				72						38990					68420	394	
FEZG40-10	40	5	3.175	1.5x2	70	104	86	16	15	102	9	40	57	M8x1	70780	136840	767
FEZG40-10				82						52080					95790	545	
FEZG50-5				63						19470					53240	451	
FEZG50-5				73						27600					79860	667	
FEZG50-5	50	6	3.969	1.5x2	72	106	88	16	15	63	9	43	59	M8x1	22230	62110	523
FEZG50-6				75						41310					110280	789	
FEZG50-6				93						58550					165430	1166	
FEZG50-6				75						41310					110280	789	
FEZG50-8	50	8	4.762	1.5x2	75	116	95	18	20	88	11	45	60	M8x1	52800	130160	843
FEZG50-8				112						74840					195240	1245	
FEZG50-8				88						52800					130160	843	
FEZG50-8				112						74840					195240	1245	

# Einzelflanschmutter

## Single flange nut

FEZG

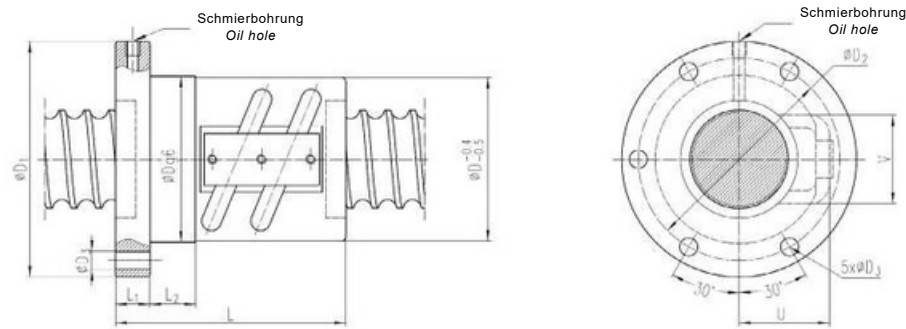

Index	Spindel Ball screw		Kugel- Ø Ball- ø	Kugelmäße Cycle number x column	D	Flansch Flange			L2	L	D3	hervorstechender Teil der Zirkulationsleitung Prominent part of circulating pipe		Øbohrung Oil hole	Nennlast rated load (N)		Steifigkeit Rigidity K N/um
	Nenn- ø Nominal- ø	Steigung Lead				D1	D2	L1				U	V		C <sub>dyn</sub>	C <sub>stat</sub>	
FEZG50-10	50	10	6.35	1.5x2	78	119	98	18	20	84	11	48	62	M8x1	50720	103930	553
FEZG50-10				74						43360					86610	464	
FEZG50-10				104						78710					173220	903	
FEZG50-10				134						111550					259830	1332	
FEZG50-10				84						57910					121250	641	
FEZG50-12	50	12	7.144	2.5x1	82	128	105	22	20	87	14	52	64	M8x1	50380	95830	478
FEZG50-12				123						91450					191670	929	
FEZG63-10	63	10	6.35	2.5x1	90	132	110	20	20	77	11	53	76	M8x1	48520	111990	541
FEZG63-10				107						88070					223990	1054	
FEZG63-10				137						124810					335990	1556	
FEZG63-12				88						64710					135420	563	
FEZG63-12	63	12	8	2.5x2	94	142	117	22	20	124	14	57	76	M8x1	117450	270840	1095
FEZG63-12				160						166460					406260	1616	
FEZG63-16				105						82840					162080	601	
FEZG63-16	63	16	9.525	2.5x1	100	150	123	22	20	153	14	62	79	M8x1	150350	324160	1167
FEZG80-10				109						96250					282280	12380	
FEZG80-10	80	10	6.35	2.5x2	115	163	137	22	20	139	14	64	91	M8x1	136410	423430	1829
FEZG80-12				125						131140					350280	1317	
FEZG80-12	80	12	8	2.5x3	120	169	143	22	25	159	14	67	94	M8x1	185850	525420	1944
FEZG80-16				156						169480					422150	1413	
FEZG80-16	80	16	9.525	2.5x2	125	190	154	28	25	204	18	70	96	M8x1	240190	633220	2084
FEZG80-16				204						240190					633220	2084	

# Doppel-Flanschmutter

## Double flange nut

FDZG

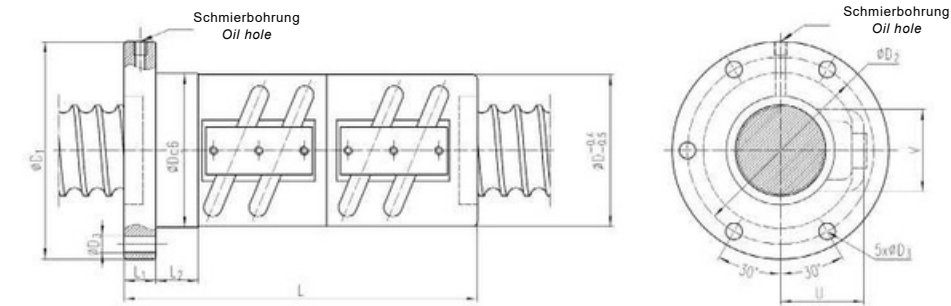

Index	Spindel Ball screw		Kugel- Ø Ball- ø	Kugelmäße Cycle number x column	D	Flansch Flange			L2	L	D3	hervorstechender Teil der Zirkulationsleitung Prominent part of circulating pipe		Øbohrung Oil hole	Nennlast rated load (N)		Steifigkeit Rigidity K N/um
	Nenn- ø Nominal- ø	Steigung Lead				D1	D2	L1				U	V		C <sub>dyn</sub>	C <sub>stat</sub>	
FDZG16-5	16	5	3.175	1.5x2	31	54	41	12	15	90	5.5	20	23	M6x1	11650	16150	407
FDZG16-5				80						9962					13460	342	
FDZG16-5				110						18080					26930	663	
FDZG16-5				90						13300					18850	471	
FDZG20-5				130						20520					485		
FDZG20-5	20	5	3.175	1.5x2	35	58	46	12	15	90	5.5	22	27	M6x1	11190	17100	407
FDZG20-5				80						20320					34210	791	
FDZG20-5				110						14950					23940	562	
FDZG20-5				90						13100					20520	485	
FDZG20-6	20	6	3.969	1.5x2	36	60	47	12	15	104	5.5	23	28	M6x1	17420	25260	498
FDZG20-6				92						14890					21050	418	
FDZG20-6				104						19890					29470	577	
FDZG25-5	25	5	3.175	1.5x2	40	64	52	12	15	90	5.5	25	32	M6x1	14560	25980	572
FDZG25-5				80						12450					21650	481	
FDZG25-5				110						22600					43300	934	
FDZG25-5				90						16630					30310	664	
FDZG25-6	25	6	3.969	1.5x2	42	68	55	12	15	104	5.5	28	33	M6x1	19580	32080	594
FDZG25-6				92						16740					26730	499	
FDZG25-6				128						30380					53470	969	
FDZG25-6				104						22360					37430	689	
FDZG25-10	25	10	4.762	1.5x2	45	72	58	16	15	136	6.6	29	35	M6x1	24940	38620	627
FDZG25-10				122						21320					32180	526	
FDZG25-10				136						28480					45060	726	
FDZG32-5	32	5	3.175	1.5x2	50	76	63	12	15	90	6.6	30	39	M6x1	16230	33610	689
FDZG32-5				80						13880					28010	578	
FDZG32-5				110						25190					56030	1124	
FDZG32-5				140						35700					84040	1650	
FDZG32-5				90						18540					39220	798	

# Doppel-Flanschmutter

## Double flange nut

FDZG

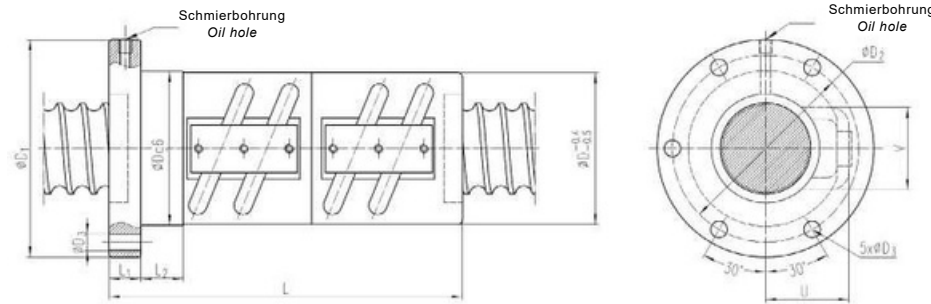

Index	Spindel Ball screw		Kugel- e Ball- e	KugelmäÙe Cycle number x column	D	Flansch Flange			L2	L	D3	hervorstechender Teil der Zirkulationsleitung Prominent part of circulating pipe		Øbohrung Oil hole	Nennlast rated load (N)		Steifigkeit Rigidity K N/um
	Nenn- e Nominal- e	Steigung Lead				D1	D2	L1				U	V		C <sub>dyn</sub>	C <sub>stat</sub>	
FDZG32-6	32	6	3.969	1.5x2	52	78	65	12	15	104	6.6	32	40	M6x1	22240	42280	728
FDZG32-6				2.5x1											19010	35230	611
FDZG32-6				2.5x2											34500	70470	1187
FDZG32-6				3.5x1											25390	49330	844
FDZG32-8	32	8	4.762	1.5x2	54	88	70	16	15	126	9	33	42	M6x1	27740	48660	737
FDZG32-8				2.5x1											23710	40550	619
FDZG32-8				2.5x2											43040	81100	1200
FDZG32-8				3.5x1											31670	56770	854
FDZG32-10	32	10	6.35	1.5x2	57	91	73	16	15	142	9	37	45	M8x1	40580	64630	774
FDZG32-10				2.5x1											34690	53860	651
FDZG32-10				2.5x2											62960	107720	1262
FDZG32-10				3.5x1											46330	75410	897
FDZG40-5	40	5	3.175	1.5x2	58	92	72	16	15	94	9	34	47	M8x1	17810	42340	798
FDZG40-5				2.5x1											15220	35280	670
FDZG40-5				2.5x2											27640	70570	1303
FDZG40-5				2.5x3											39170	105850	1922
FDZG40-5				3.5x1											20340	49400	925
FDZG40-6	40	6	3.969	1.5x2	60	94	76	16	15	108	9	36	48	M8x1	24270	52540	839
FDZG40-6				2.5x1											20740	43780	704
FDZG40-6				2.5x2											37660	87570	1369
FDZG40-6				2.5x3											53370	131350	2019
FDZG40-6				3.5x1											27710	61290	973
FDZG40-8	40	8	4.762	1.5x2	62	96	78	16	15	126	9	38	50	M8x1	31360	63300	889
FDZG40-8				2.5x1											26810	52750	747
FDZG40-8				2.5x2											48660	105510	1450
FDZG40-8				3.5x1											35800	73860	1030
FDZG40-10	40	10	6.35	1.5x2	65	106	85	18	20	152	11	42	52	M8x1	45610	82100	922
FDZG40-10				2.5x1											38990	68420	774
FDZG40-10				2.5x2											70780	136840	1502
FDZG40-10				3.5x1											52080	95790	1068

# Doppel-Flanschmutter

## Double flange nut

FDZG

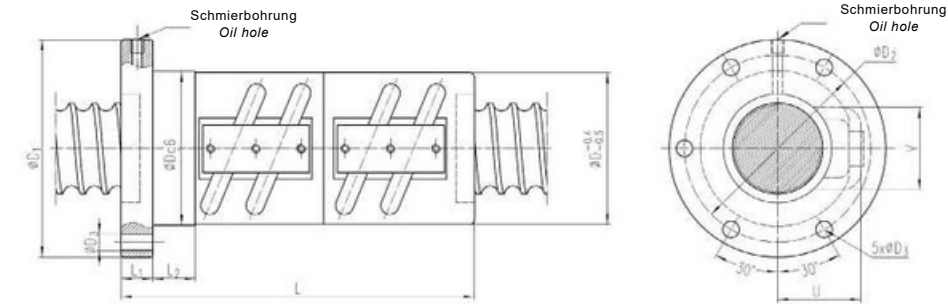

Index	Spindel Ball screw		Kugel- e Ball- e	KugelmäÙe Cycle number x column	D	Flansch Flange			L2	L	D3	hervorstechender Teil der Zirkulationsleitung Prominent part of circulating pipe		Øbohrung Oil hole	Nennlast rated load (N)		Steifigkeit Rigidity K N/um
	Nenn- e Nominal- e	Steigung Lead				D1	D2	L1				U	V		C <sub>dyn</sub>	C <sub>stat</sub>	
FDZG50-5	50	5	3.175	1.5x2	70	104	86	16	15	107	9	40	57	M8x1	19470	53240	925
FDZG50-5				1.5x3						127					27600	79860	1360
FDZG50-5				3.5x1						107					22230	62110	1072
FDZG50-6				2.5x2						134					41310	110280	1596
FDZG50-6	50	6	3.969	2.5x3	72	106	88	16	15	170	9	43	59	M8x1	58550	165430	2355
FDZG50-8				2.5x2						160					52800	130160	1679
FDZG50-8	50	8	4.762	2.5x3	75	116	95	18	20	208	11	45	60	M8x1	74840	195240	2475
FDZG50-10				1.5x2						154					50720	103930	1093
FDZG50-10	50	10	6.35	2.5x1	78	119	98	18	20	134	11	48	62	M8x1	43360	86610	918
FDZG50-10				2.5x2						194					78710	173220	1783
FDZG50-10				2.5x3						254					111550	259830	2628
FDZG50-10				3.5x1						154					57910	121250	1267
FDZG50-12	50	12	7.144	2.5x1	82	128	105	22	20	160	14	52	64	M8x1	50380	95830	937
FDZG50-12				2.5x2						232					91450	191670	1819
FDZG63-10	63	10	6.35	2.5x1	90	132	110	20	20	136	11	53	76	M8x1	48520	111990	1087
FDZG63-10				2.5x2						196					88070	223990	2113
FDZG63-10				2.5x3						256					124810	335990	3116
FDZG63-12	63	12	8	2.5x1	94	142	117	22	20	160	14	57	76	M8x1	64710	135420	1118
FDZG63-12				2.5x2						232					117450	270840	2172
FDZG63-12				2.5x3						304					166460	406260	3203
FDZG63-16	63	16	9.525	2.5x1	100	150	123	22	20	200	14	62	79	M8x1	82840	162080	1178
FDZG63-16				2.5x2						296					150350	324160	2286
FDZG80-10	80	10	6.35	2.5x2	115	163	137	22	20	200	14	64	91	M8x1	96250	282280	2496
FDZG80-10				2.5x3						260					136410	423430	3682
FDZG80-12	80	12	8	2.5x2	120	169	143	22	25	232	14	67	94	M8x1	131140	350280	2627
FDZG80-12				2.5x3						302					185850	525420	3874
FDZG80-16	80	16	9.525	2.5x2	125	190	154	28	25	302	18	70	96	M8x1	169480	422150	2784
FDZG80-16				2.5x3						398					240190	633220	4103

# Einzelflanschmutter

## Single flange nut

FEVG

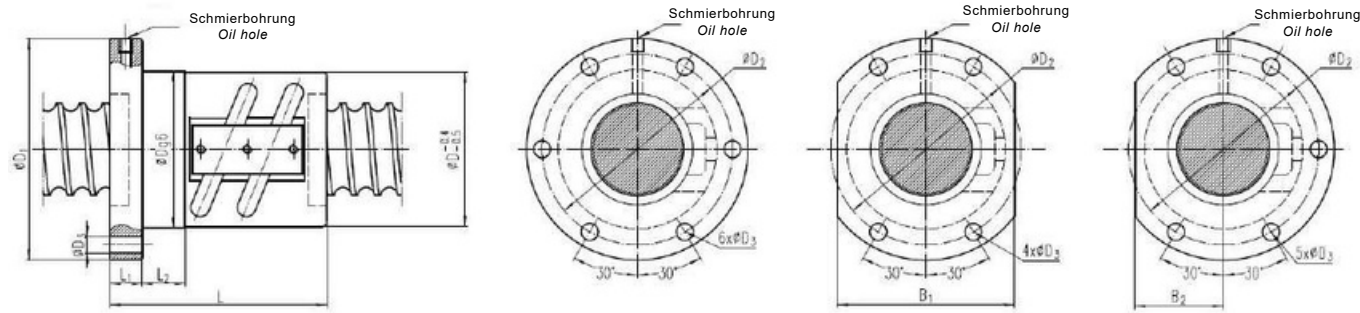

Index	Spindel Ball screw		Kugel- e Ball- e	Kugelmilife Cycle number x column	D	Flansch Flange					L2	L	D3	Obbohrung Oil hole	Nennlast rated load (N)		Stiffigkeit Rigidity K N/um		
	Nenn- e Normal- e	Steigung Lead				D1	D2	B1	B2	L1					C <sub>dyn</sub>	C <sub>stat</sub>			
FEVG16-4	16	4	2.5	1.5x2	34	57	45	34	17	11	10	44	5.5	M6x1	7960	12160	201		
FEVG16-4		4		2.5x1											41	6810	10130	168	
FEVG16-4		4		3.5x1											42	9090	14190	233	
FEVG16-5		5		1.5x2											45	11650	16150	212	
FEVG16-5	16	5	3.175	2.5x1	40	63	51	42	21	11	15	41	5.5	M6x1	9960	13460	178		
FEVG16-5		5		2.5x2											56	18080	26930	346	
FEVG16-5		5		3.5x1											46	13300	18850	246	
FEVG16-6	16	6	3.175	1.5x2	40	63	51	42	21	11	15	52	5.5	M6x1	11620	16120	213		
FEVG16-6		6		2.5x1											44	9930	13430	179	
FEVG16-6		6		3.5x1											52	13270	18810	247	
FEVG16-10		10		2.5x1											56	9790	13290	178	
FEVG20-4	20	4	2.5	1.5x2	40	64	51	42	21	11	15	44	5.5	M6x1	9000	15820	243		
FEVG20-4		4		2.5x1											40	7690	13180	204	
FEVG20-4		4		2.5x2											50	13970	26370	396	
FEVG20-4		4		3.5x1											43	10280	18460	282	
FEVG20-5	20	5	3.175	1.5x2	44	67	55	52	26	11	15	15	45	5.5	M6x1	13100	20520	253	
FEVG20-5		5		2.5x1												10	11190	17100	212
FEVG20-5		5		2.5x2												56	20320	34210	412
FEVG20-5		5		3.5x1												46	14950	23940	293
FEVG20-6		6		1.5x2												56	17420	25260	261
FEVG20-6	20	6	3.969	2.5x1	48	71	59	54	27	11	15	49	5.5	M6x1	14890	21050	219		
FEVG20-6		6		3.5x1											56	19890	29470	302	
FEVG20-8		8		1.5x2											61	17350	25180	263	
FEVG20-8	20	8	3.969	2.5x1	48	75	61	54	27	13	15	54	6.6	M6x1	14830	20980	221		
FEVG20-8		8		3.5x1											62	19810	29370	305	
FEVG25-4		4		1.5x2											44	9770	19520	280	
FEVG25-4	25	4	2.5	2.5x1	46	69	57	52	26	11	15	40	5.5	M6x1	8350	16270	235		
FEVG25-4		4		2.5x2											49	15160	32540	456	
FEVG25-4		4		3.5x1											42	11150	22770	324	
FEVG25-5		5		1.5x2											45	14560	25980	299	
FEVG25-5	25	5	3.175	2.5x1	50	73	61	56	28	11	15	41	5.5	M6x1	12450	21650	251		
FEVG25-5		5		2.5x2											56	22600	43300	487	
FEVG25-5		5		3.5x1											46	16630	30310	346	

# Einzelflanschmutter

## Single flange nut

FEVG

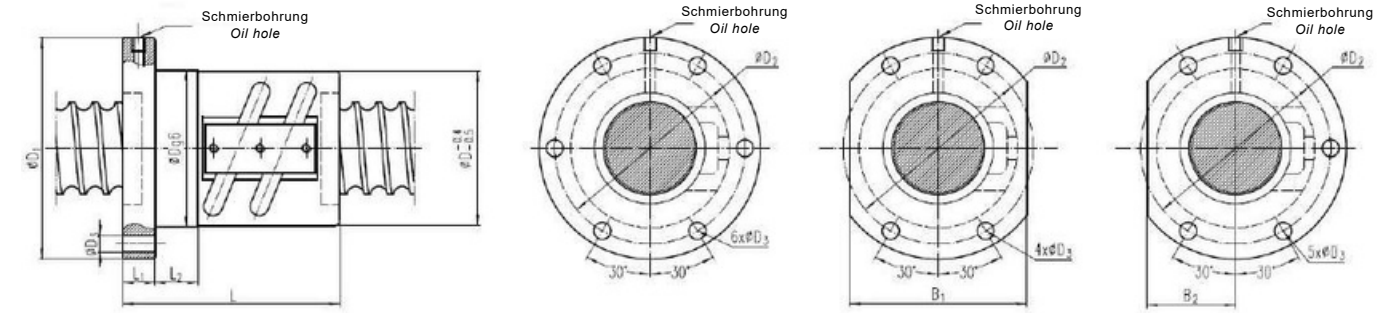

Index	Spindel Ball screw		Kugel- e Ball- e	Kugelmilife Cycle number x column	D	Flansch Flange					L2	L	D3	Obbohrung Oil hole	Nennlast rated load (N)		Stiffigkeit Rigidity K N/um	
	Nenn- e Normal- e	Steigung Lead				D1	D2	B1	B2	L1					C <sub>dyn</sub>	C <sub>stat</sub>		
FEVG25-6	25	6	3.969	1.5x2	53	76	64	58	29	11	15	56	5.5	M6x1	19580	32080	310	
FEVG25-6		6		2.5x1											49	16740	26730	260
FEVG25-6		6		2.5x2											62	30380	53470	506
FEVG25-6		6		3.5x1											56	22360	37430	360
FEVG25-8	25	8	4.762	1.5x2	58	85	71	64	32	13	15	61	6.6	M6x1	25030	38720	326	
FEVG25-8		8		2.5x1											61	21390	32270	274
FEVG25-8		8		3.5x1											66	28570	45180	378
FEVG25-10	25	10	4.762	1.5x2	58	85	71	64	32	15	15	71	6.6	M6x1	24940	38620	328	
FEVG25-10		10		2.5x1											65	21320	32188	276
FEVG25-10		10		3.5x1											75	28480	45060	380
FEVG25-12	25	12	3.969	2.5x1	53	76	64	64	32	11	15	60	5.5	M6x1	16560	26520	266	
FEVG32-4	32	4	2.5	2.5x1	54	81	67	64	32	12	15	40	6.6	M6x1	9350	21370	280	
FEVG32-4		4		2.5x2											50	16980	42740	546
FEVG32-5	32	5	3.175	1.5x2	58	85	71	64	32	12	15	47	6.6	M8x1	16230	33610	355	
FEVG32-5		5		2.5x1											43	13880	28010	298
FEVG32-5		5		2.5x2											57	25190	56030	580
FEVG32-5		5		3.5x1											72	35700	84040	856
FEVG32-5	32	5	4.762	3.5x1	62	88	75	68	34	12	15	47	6.6	M8x1	18540	39220	412	
FEVG32-6		6		1.5x2											57	22240	42280	377
FEVG32-6		6		2.5x1											45	19010	35230	317
FEVG32-6	32	6	3.969	2.5x2	62	88	75	68	34	12	15	63	6.6	M8x1	34500	70470	616	
FEVG32-6		6		3.5x1											57	25390	49330	438
FEVG32-8		8		1.5x2											64	27740	48660	384
FEVG32-8	32	8	4.762	2.5x1	66	98	82	76	38	15	15	63	9	M8x1	23710	40550	323	
FEVG32-8		8		2.5x2											80	43040	81100	626
FEVG32-8		8		3.5x1											68	31670	56770	445
FEVG32-10		10		1.5x2											78	40580	64630	405
FEVG32-10	32	10	6.35	2.5x1	74	108	90	82	41	15	15	68	9	M8x1	34690	53860	340	
FEVG32-10		10		2.5x2											97	62960	107720	661
FEVG32-10		10		3.5x1											78	46330	75410	470
FEVG32-12	32	12	6.35	1.5x2	74	108	90	82	41	18	15	88	9	M8x1	40470	64510	408	
FEVG32-12		12		2.5x1											77	34600	53750	342
FEVG32-12		12		2.5x2											110	62800	107510	664
FEVG32-12		12		3.5x1											91	46210	75260	472

# Einzelflanschmutter

## Single flange nut

FEVG

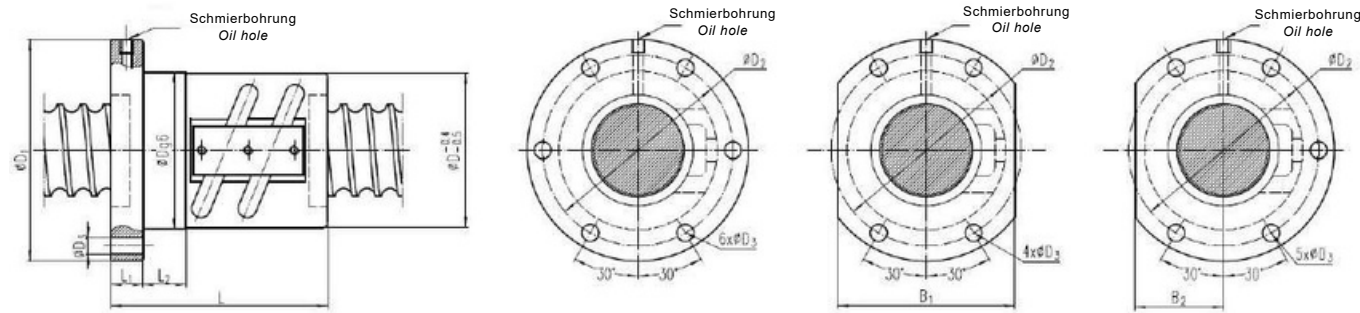

Index	Spindel Ball screw		Kugel-ø Ball-ø	Kugelumläufe Cycle number x column	D	Flansch Flange					L2	L	D3	Oberbohrung Oil hole	Nennlast rated load (N)		Steifigkeit Rigidity K N/um
	Nenn-ø Nominal-ø	Steigung Lead				D1	D2	B1	B2	L1					C <sub>0</sub>	C <sub>stat</sub>	
FEVG40-5	40	5	3.175	1.5x2	67	101	83	78	39	15	15	50	9	M8x1	17810	42340	412
FEVG40-5		5		2.5x1								48			15220	35280	346
FEVG40-5		5		2.5x2								60			27640	70570	673
FEVG40-5		5		2.5x3								75			39170	105850	994
FEVG40-5		5		3.5x1								50			20340	49400	478
FEVG40-6	40	6	3.969	1.5x2	70	104	86	80	40	15	15	60	9	M8x1	24270	52540	434
FEVG40-6		6		2.5x1								53			20740	43780	365
FEVG40-6		6		2.5x2								66			37660	87570	709
FEVG40-6		6		2.5x3								84			53370	131350	1047
FEVG40-6		6		3.5x1								60			27710	61290	504
FEVG40-8	40	8	4.762	1.5x2	74	108	90	82	41	15	15	64	9	M8x1	31360	63300	463
FEVG40-8		8		2.5x1								63			26810	52750	389
FEVG40-8		8		2.5x2								83			48660	105510	755
FEVG40-8		8		3.5x1								68			35800	73860	537
FEVG40-10	40	10	6.35	1.5x2	82	124	102	94	47	18	20	81	11	M8x1	45610	82100	482
FEVG40-10		10		2.5x1								71			38990	68420	405
FEVG40-10		10		2.5x2								103			70780	136840	787
FEVG40-10		10		3.5x1								81			52080	95790	559
FEVG40-12	40	12	6.35	2.5x1	86	128	106	96	48	18	20	77	11	M8x1	38930	68330	410
FEVG40-12		12		2.5x2								112			70660	136670	796
FEVG40-12		12		3.5x1								91			51990	95670	566
FEVG40-5	50	5	3.175	1.5x2	80	114	96	86	43	15	15	50	9	M8x1	19470	53240	476
FEVG40-5		5		1.5x3								60			27600	79860	703
FEVG40-5		5		2.5x2								60			30210	88740	778
FEVG40-5		5		3.5x1								50			22230	62110	552
FEVG50-6	50	6	3.969	1.5x2	84	118	100	90	45	15	15	60	9	M8x1	26620	66170	506
FEVG50-6		6		2.5x2								67			41310	110280	827
FEVG50-6		6		2.5x3								85			58550	165430	1220
FEVG50-6		6		3.5x1								60			30400	77200	587

# Einzelflanschmutter

## Single flange nut

FEVG

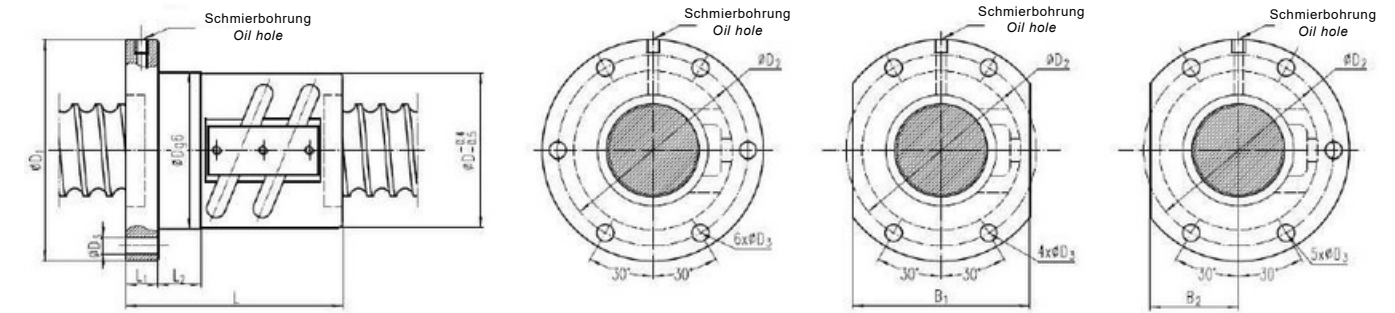

Index	Spindel Ball screw		Kugel-ø Ball-ø	Kugelumläufe Cycle number x column	D	Flansch Flange					L2	L	D3	Oberbohrung Oil hole	Nennlast rated load (N)		Steifigkeit Rigidity K N/um
	Nenn-ø Nominal-ø	Steigung Lead				D1	D2	B1	B2	L1					C <sub>0</sub>	C <sub>stat</sub>	
FEVG50-8	50	8	4.762	1.5x2	87	128	107	98	49	18	20	68	11	M8x1	34030	78090	533
FEVG50-8		8		2.5x2								86			52800	130160	870
FEVG50-8		8		2.5x3								109			74840	195240	1284
FEVG50-8		8		3.5x1								71			38850	91110	618
FEVG50-10		50		10								6.35			1.5x2	93	135
FEVG50-10	10		2.5x1	71	43360	86610	478										
FEVG50-10	10		2.5x2	101	78710	173220	929										
FEVG50-10	10		2.5x3	131	111550	259830	1369										
FEVG50-10	10		3.5x1	81	57910	121250	660										
FEVG50-12	50	12	7.144	2.5x1	100	146	122	110	55	22	20	88	14	M8x1	50380	95830	489
FEVG50-12		12		2.5x2								116			91450	191670	949
FEVG63-10	63	10	6.35	2.5x1	108	154	130	116	58	22	20	75	14	M8x1	48520	111990	569
FEVG63-10		10		2.5x2								105			88070	223990	1107
FEVG63-10		10		2.5x3								135			124810	335990	1633
FEVG63-12	63	12	8	2.5x1	115	161	137	122	61	22	20	88	14	M8x1	64710	135420	586
FEVG63-12		12		2.5x2								124			117450	270840	1139
FEVG63-12		12		2.5x3								160			166460	406260	1679
FEVG80-10	80	10	6.35	2.5x2	130	176	152	132	66	22	20	105	14	M8x1	96250	282280	1286
FEVG80-10		10		2.5x3								134			136410	423430	1898
FEVG80-12		12	8	2.5x2								124			131140	350280	1356
FEVG80-12		12		2.5x3								160			185850	525420	2001
FEVG80-16		16		2.5x2								160			169480	422150	1444
FEVG80-16	16	2.5x3	208	240190	633220	2129											

# Doppel-Flanschmutter

## Double flange nut

FDVG

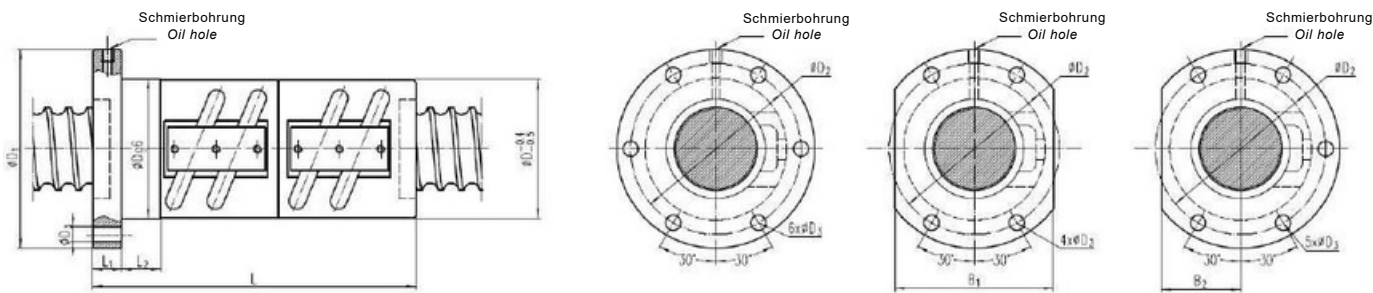

Index	Spindel Ball screw		Kugel- Ball- $\phi$	Kugelm $\ddot{u}$ hle Cycle number $\times$ column	D	Flansch Flange					L2	L	D3	Obbohrung Oil hole	Nennlast rated load (N)		Steifigkeit Rigidity K N/um
	Nenn- $\phi$ Nominal- $\phi$	Steigung Lead				D1	D2	B1	B2	L1					C <sub>dyn</sub>	C <sub>stat</sub>	
FDVG16-4		4		1.5x2							81				7967	12460	390
FDVG16-4	16	4	2.5	2.5x1	34	57	45	34	17	11	15	70	5.5	M6x1	6810	10137	328
FDVG16-4		4		3.5x1							78				9096	14190	452
FDVG16-5		5		1.5x2							90				11650	16150	410
FDVG16-5	16	5	3.175	2.5x1	40	63	51	40	20	11	15	77	5.5	M6x1	9962	13460	345
FDVG16-5		5		2.5x2							105				18080	26930	346
FDVG16-5		5		3.5x1							88				13300	18850	476
FDVG16-5		6		1.5x2							90				11620	16120	411
FDVG16-5	16	6	3.175	2.5x1	40	63	51	40	20	11	15	80	5.5	M6x1	9930	13430	345
FDVG16-5		6		3.5x1							90				13270	18810	477
FDVG20-4		4		1.5x2							83				9000	15820	476
FDVG20-4	20	4	2.5	2.5x1	40	63	51	48	24	11	15	67	5.5	M6x1	7699	13180	399
FDVG20-4		4		2.5x2							89				13970	26370	396
FDVG20-4		4		3.5x1							75				10280	18460	550
FDVG20-5		5		1.5x2							99				13100	20520	491
FDVG20-5	20	5	3.175	2.5x1	44	67	55	52	26	11	15	76	5.5	M6x1	11190	17100	413
FDVG20-5		5		2.5x2							105				20320	34210	801
FDVG20-5		5		3.5x1							80				14950	23940	569
FDVG20-6		6		1.5x2							98				17420	25260	505
FDVG20-6	20	6	3.969	2.5x1	48	71	59	54	27	11	15	82	5.5	M6x1	14890	21050	424
FDVG20-6		6		3.5x1							93				19890	29470	585
FDVG20-8		8		1.5x2							108				17350	25180	507
FDVG20-8	20	8	3.969	2.5x1	48	75	61	56	28	13	15	102	6.6	M6x1	14830	20980	426
FDVG20-8		8		3.5x1							110				19810	29370	587
FDVG25-4		4		1.5x2							83				9773	19520	551
FDVG25-4	25	4	2.5	2.5x1	46	69	57	52	26	11	15	67	5.5	M6x1	8355	16270	463
FDVG25-4		4		2.5x2							91				15160	32540	899
FDVG25-4		4		3.5x1							75				11150	22770	324
FDVG25-5		5		1.5x2							80				14560	25980	584
FDVG25-5	25	5	3.175	2.5x1	50	73	61	56	28	11	15	77	5.5	M6x1	12450	21650	491
FDVG25-5		5		2.5x2							105				22600	43300	953
FDVG25-5		5		3.5x1							86				16630	30310	677

# Doppel-Flanschmutter

## Double flange nut

FDVG

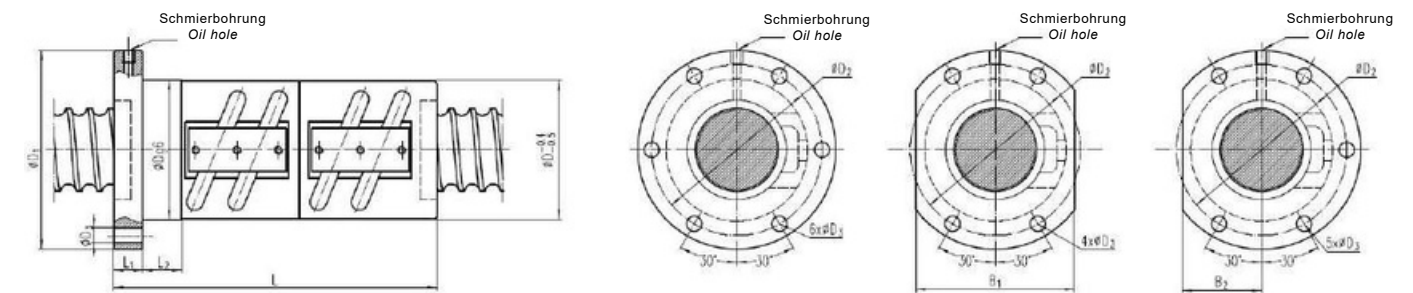

Index	Spindel Ball screw		Kugel- Ball- $\phi$	Kugelm $\ddot{u}$ hle Cycle number $\times$ column	D	Flansch Flange					L2	L	D3	Obbohrung Oil hole	Nennlast rated load (N)		Steifigkeit Rigidity K N/um
	Nenn- $\phi$ Nominal- $\phi$	Steigung Lead				D1	D2	B1	B2	L1					C <sub>dyn</sub>	C <sub>stat</sub>	
FDVG25-6		6		1.5x2							91				19580	32080	604
FDVG25-6	25	6	3.969	2.5x1	53	76	64	58	29	11	15	82	5.5	M6x1	16740	26730	507
FDVG25-6		6		2.5x2							116				30380	53470	984
FDVG25-6		6		3.5x1							93				22360	37430	700
FDVG25-8		8		1.5x2							111				25030	38720	631
FDVG25-8	25	8	4.762	2.5x1	58	85	71	64	32	13	15	95	6.6	M6x1	21390	32270	530
FDVG25-8		8		3.5x1							111				28570	45180	731
FDVG25-10		10		1.5x2							134				24940	38620	632
FDVG25-10	25	10	4.762	2.5x1	58	85	71	64	32	15	15	117	6.6	M6x1	21320	32180	531
FDVG25-10		10		3.5x1							138				28480	45060	733
FDVG32-4		4	2.5	2.5x1	54	81	67	64	32	12	15	68	6.6	M6x1	9359	21370	560
FDVG32-4	32	4		2.5x2							90				16980	42740	1087
FDVG32-5		5		1.5x2							82				16230	33610	702
FDVG32-5	32	5	3.175	2.5x1	58	85	71	64	32	12	15	78	6.6	M8x1	13880	28010	589
FDVG32-5		5		2.5x3							105				25190	56030	1145
FDVG32-5		5		3.5x1							82				35700	84040	1680
FDVG32-5		5		3.5x1							82				18540	39220	814
FDVG32-6		6		1.5x2							100				22240	42280	740
FDVG32-6	32	6	3.969	2.5x1	62	88	75	68	34	12	15	87	6.6	M8x1	19010	35230	622
FDVG32-6		6		2.5x2							123				34500	70470	1207
FDVG32-6		6		3.5x1							100				25390	49330	858
FDVG32-8		8		1.5x2							113				27740	48660	747
FDVG32-8	32	8	4.762	2.5x1	66	98	82	76	38	15	15	106	9	M8x1	23710	40550	627
FDVG32-8		8		2.5x2							152				43040	81100	1217
FDVG32-8		8		3.5x1							113				31670	56770	865
FDVG32-10		10		1.5x2							138				40580	64630	784
FDVG32-10	32	10	6.35	2.5x1	74	108	90	82	41	15	15	118	9	M8x1	34690	53860	659
FDVG32-10		10		2.5x2							177				62960	107720	1277
FDVG32-10		10		3.5x1							148				46330	75410	908

# Doppel-Flanschmutter

## Double flange nut

FDVG

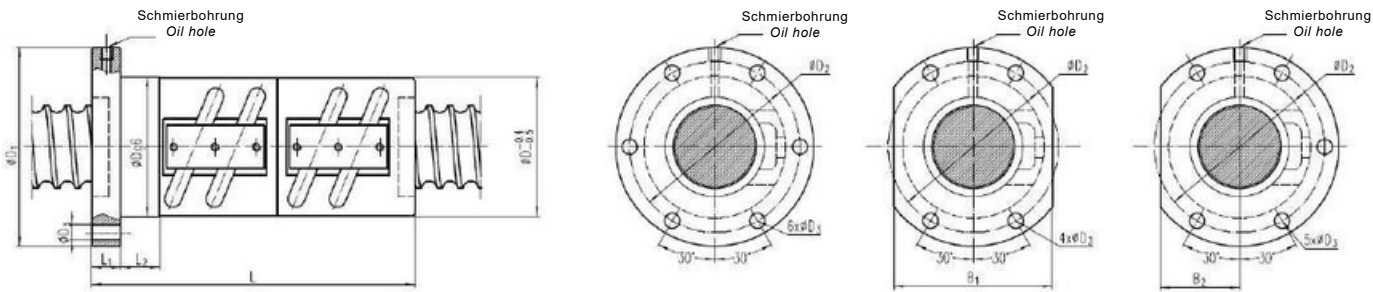

Index	Spindel Ball screw		Kugel- Ball- a	Kugelumlaufe Cycle number x column	D	Flansch Flange					L2	L	D3	Ölbohrung Oil hole	Nennlast rated load (N)		Steifigkeit Rigidity K N/um	
	Nenn- Nominal- a	Steigung Lead				D1	D2	B1	B2	L1					C <sub>dyn</sub>	C <sub>stat</sub>		
FDVG32-12	32	12	6.35	1.5x2	74	108	90	82	41	18	15	160	9	M8x1	40470	64510	786	
FDVG32-12		12		2.5x1								137			34600	53750	660	
FDVG32-12		12		2.5x2								208			62800	107510	1280	
FDVG32-12		12		3.5x1								160			46210	75260	910	
FDVG40-5	40	5	3.175	1.5x2	67	101	83	78	39	15	15	88	9	M8x1	17810	42340	822	
FDVG40-5		5		2.5x1								84			15220	35280	690	
FDVG40-5		5		2.5x2								108			27640	70570	1341	
FDVG40-5		5		2.5x3								139			39170	105850	1978	
FDVG40-5	5	3.5x1	88	20340	49400	953												
FDVG40-6	40	6	3.969	1.5x2	70	104	86	80	40	15	15	103	9	M8x1	24270	52540	860	
FDVG40-6		6		2.5x1								90			20740	43780	722	
FDVG40-6		6		2.5x2								123			37660	87570	1403	
FDVG40-6		6		2.5x3								159			53370	131350	2068	
FDVG40-6	6	3.5x1	103	27710	61290	997												
FDVG40-8	40	8	4.762	1.5x2	74	108	90	82	41	15	15	124	9	M8x1	31360	63300	907	
FDVG40-8		8		2.5x1								108			26810	52750	762	
FDVG40-8		8		2.5x2								152			48660	105510	1478	
FDVG40-8		8		3.5x1								125			35800	73860	1051	
FDVG40-10	40	10	6.35	1.5x2	82	124	102	94	47	18	20	141	11	M8x1	45610	82100	938	
FDVG40-10		10		2.5x1								131			38990	68420	788	
FDVG40-10		10		2.5x2								180			70780	136840	1529	
FDVG40-10		10		3.5x1								151			52080	95790	1087	
FDVG40-12	40	12	6.35	2.5x1	86	128	106	96	48	18	20	137	11	M8x1	38930	68330	794	
FDVG40-12		12		2.5x2								208			70660	136670	1539	
FDVG40-12		12		3.5x1								161			51990	95670	1095	
FDVG50-5	50	5	3.175	1.5x2	80	114	96	86	43	15	15	108	9	M8x1	19470	53240	960	
FDVG50-5				1.5x3								128			27600	79860	1416	
FDVG50-5				2.5x2								113			30210	88740	1566	
FDVG50-5				3.5x1								108			22230	62110	1112	

# Doppel-Flanschmutter

## Double flange nut

FDVG

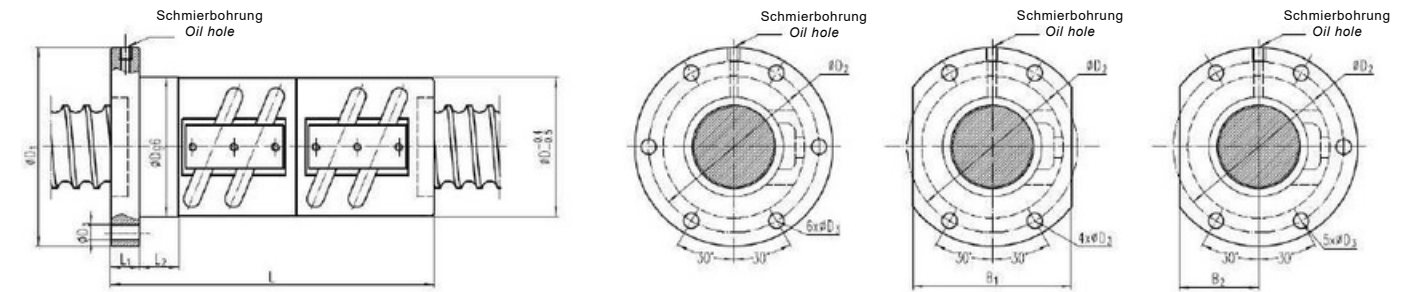

Index	Spindel Ball screw		Kugel- Ball- a	Kugelumlaufe Cycle number x column	D	Flansch Flange					L2	L	D3	Ölbohrung Oil hole	Nennlast rated load (N)		Steifigkeit Rigidity K N/um									
	Nenn- Nominal- a	Steigung Lead				D1	D2	B1	B2	L1					C <sub>dyn</sub>	C <sub>stat</sub>										
FDVG50-6	50	6	3.969	1.5x2	84	118	100	90	45	15	15	111	9	M8x1	26620	66170	1011									
FDVG50-6				2.5x2								123			41310	110280	1649									
FDVG50-6				2.5x3								159			58550	165430	2431									
FDVG50-6				3.5x1								107			30400	77200	1171									
FDVG50-8	50	8	4.762	1.5x2	87	128	107	98	49	18	20	127	11	M8x1	34030	78090	1050									
FDVG50-8				2.5x2								156			52800	130160	1715									
FDVG50-8				2.5x3								208			74840	195240	2527									
FDVG50-8				3.5x1								127			38850	91110	1219									
FDVG50-10	50	10	6.35	1.5x2	93	135	113	102	51	18	20	151	11	M8x1	50720	103930	1114									
FDVG50-10				2.5x1								132			43360	86610	936									
FDVG50-10				2.5x2								180			78710	173220	1817									
FDVG50-10				2.5x3								243			111550	259830	2677									
FDVG50-10	3.5x1	151	57910	121250	1292																					
FDVG50-12	50	12	7.144	2.5x1	100	146	122	110	55	18	20	140	14	M8x1	50380	95830	951									
FDVG50-12				2.5x2								210			91450	191670	1845									
FDVG63-10	63	10	6.35	2.5x1	108	154	130	116	58	22	20	136	14	M8x1	48520	111990	1125									
FDVG63-10				2.5x2								189			88070	223990	2185									
FDVG63-10		2.5x3	249	124810								335990			3220											
FDVG63-12		12	8	2.5x1								115			161	137	122	61	22	20	144	14	M8x1	64710	135420	1140
FDVG63-12	2.5x2			214	117450	270840	2231																			
FDVG63-16	16	9.525	2.5x1	122	178	150	138	69	28	20	200	18	M8x1	82840	162080	1198										
FDVG63-16			2.5x2								296			150350	324160	2324										
FDVG80-10	80	10	6.35	2.5x2	130	176	152	132	66	22	20	189	14	M8x1	96250	282280	2562									
FDVG80-10				2.5x3								249			136410	423430	3778									
FDVG80-12		12	8	2.5x2								136			182	158	136	68	22	20	220	14	M8x1	131140	350280	2681
FDVG80-12				2.5x3																	292			185850	525420	3952
FDVG80-16	16	9.525	2.5x2	143	204	172	154	77	28	30	290	18	M8x1	169480	422150	2825										
FDVG80-16			2.5x3								386			240190	633220	4163										